

WAFER CHECK VALVES

05 SYSTEM DOUBLE PLATE



DISTRIBUTION



TREATMENT



INDUSTRY



IRRIGATION

DN 2" to 24"

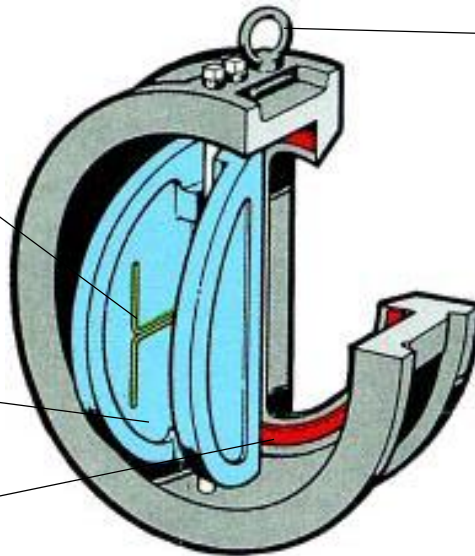

Watertightness ensured by the spring which pushes against the two plates, maintaining pressure on the valve seat seal

Very little energy loss

Gradual opening controlled by double contact spring

Stainless steel or bronze plates

Vulcanised NBR seal in mouth of the valve seat

Lifting ring for easy positioning pushes against the two plates, maintaining pressure on the valve seat seal

Can be installed horizontally or vertically facing upwards.
Can be adapted for different connection types:
PN 10 - 16 - 25 - ASA B 16-1
125 Class and ASA B 16-5
150 series

Installation



* Please consult with us if need big sizes

895-895V TYPE HEADLOSS CHART

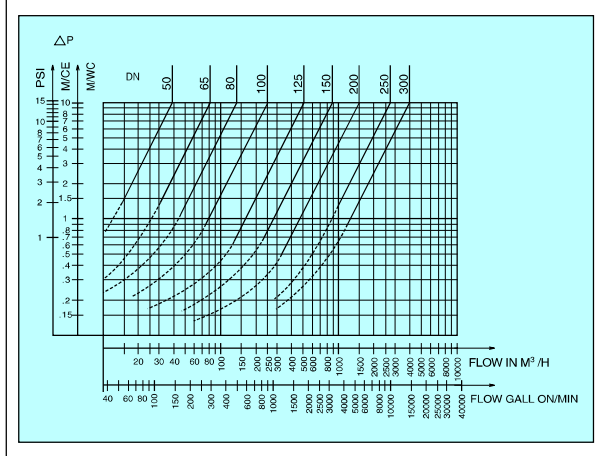

MATERIALS



NOMENCLATURE	805	815	825	895	895V
① Casing	Cast iron A126 class B	ductile iron A5366 04018	stainless steel AISI 316	Cast iron FGL250(≤ 150) Cast iron GS400-15(> 150)	
② Plate	Alu-bronze	Alu-bronze ≥ 350 Stainless Steel < 350		stainless steel AISI304	
③ spring	stainless steel AISI1316			stainless steel AISI316	
④ seat	NBR	NBR	Viton	NBR	Viton
⑤ pins	stainless steel AISI316			stainless steel AISI304	
⑥ bearing	PTFE				
⑦ Eye bolt	steel E24				
MAX.OPERATING PRESSURE	16	25	25	16	
TEMPERATURE	-20° +130°	-20° +130°	-20° +140°	-20° +130°	

Type 895

- Stainless steel heart against corrosion
- Reinforced sealing for improved safety.
- lower headloss to maximise flow

05 SYSTEM-SINGLE PLATE

DIMENSION

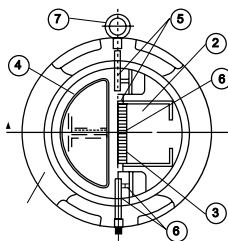
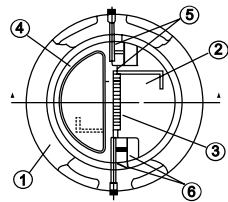

Type 805-895-895V

Ref. 805	Ref. 895V	Ref. 895	ND		øA	øA	B	øC	D	Gr	weight
			mm	Inch	PN10/16	ASME150					
3270	3000V	3000	50	2"	109	105	54	60	27	27	1,2
3271	3001V	3001	65	2 1/2"	129	124	54	73	27	34	1,8
3272	3002V	3002	80	3"	144	137	57	89	28	42	2,9
3273	3003V	3003	100	4"	164	175	64	114	30	53	3,9
3274	3004V	3004	125	5"	194	197	70	141	31	65	5,8
3275	3005V	3005	150	6"	220	222	76	168	31	79	8
3276	3006V	3006	200	8"	275	279	95	219	41	102	14
14319	3007V	3007	250	10"	330	340	108	273	41	126	22
14321	3008V	3008	300	12"	380	410	143	324	56	153	34
2590	-	-	350	14"	440	451	184	356	94	175	75
2591	-	-	400	16"	491	514	191	406	89	194	105
2592	-	-	450	18"	541	549	203	457	89	218	144
2593	-	-	500	20"	596	606	213	508	89	243	186
2594	-	-	600	24"	698	718	222	610	87	291	240

**Sizes over 24": consult us

Type 815-825

Ref. 815	Ref. 825	ND		øA	B	øC	D	Gr	Weight Kg
		mm	Inch						
3290	2660	50	2"	109	54	60	27	27	2,5
3291	2661	65	2 1/2"	129	54	73	27	34	3,2
3292	2662	80	3"	144	57	89	28	42	3,4
3293	2663	100	4"	170	64	114	30	53	5,6
3294	2664	125	5"	194	70	141	31	65	8,1
3295	2665	150	6"	220	76	168	31	79	10,4
3296	2666	200	8"	286	95	219	41	102	18,5
14323	2667	250	10"	340	108	273	41	126	29,5
14325	2668	300	12"	403	143	324	56	153	44,1
2650	2669	350	14"	460	184	356	94	175	78
2651	*	400	16"	517	191	406	89	195	110
2652		450	18"	567	203	457	89	218	146,9
2653		500	20"	627	213	508	89	243	189,7
2654*		600	24"						

*For JIS 10 K centering: consult us.

DN50-150 DN200-600

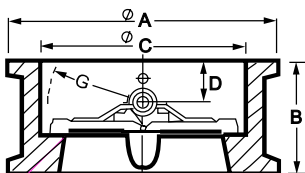

605/615: a range of simple, cost effective swing check valves for use with water, gases, air, fuels and hydrocarbons. They are available in cast iron, carbon steel and stainless steel.